

Scheda Tecnica *Technical Sheet*

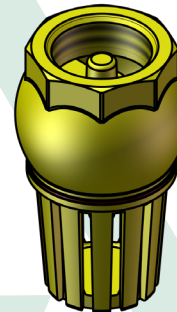
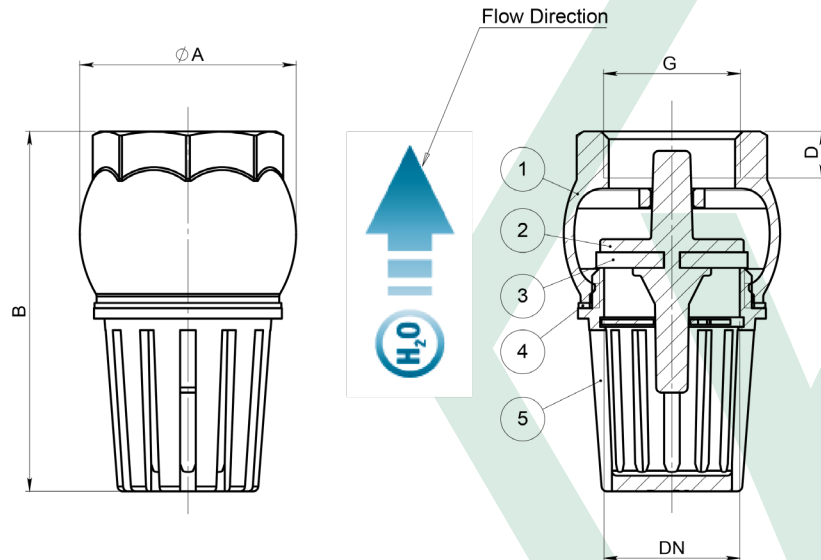

ART.0195	
<i>Hotpressed brass foot valve</i>	
SPECIFICATION	
Series	195
Thread ends	Female: ISO228/1
Actuator	-
Operator	-
APPLICATION	
Assembly in rigid pipe system	
Nominal pressure (PN) in bar	
Direction of flow: only one direction	
Temperature range: 0 °C / +90°C	
Use: Water	

N°	Descrizione	Part name	Materiale	Q.tà
1	Corpo	Body	CW617N	1
2	Otturatore	Disc	CW614N	1
3	Guarnizione otturatore	Gasket disk	SBR	1
4	Guarnizione	Gasket	FIBER	1
5	Filtro	Filter	CW617N	1

NB. Misure: 2"1/2 - 3" - 4" con filetto NPT a richiesta

DN	G	A	B	D	PN
23	3/4"	45	73	10	10
28	1"	51	81	12	10
34	1"1/4	61	95	13	8
41	1"1/2	68	103	13	8
51	2"	80	121	15	8
62	2"1/2	103	136	12	6
73	3"	115	151	15	6
93	4"	145	187	22	6

N° Disegno / Drawing Nr.	Misura / Size	BUGATTI[®] VALVOSANITARIA	UFFICIO TECNICO
0195	3/4"-4"		